



# iOS User Guide to install and activate your eSIM



## Before you begin the installation

We highly recommend installing and activating your eSIM only after arriving at your destination in Mexico.

**1**

### **Make sure your device**

is eSIM compatible and is not locked to any carrier before installing it.

**2**

### **Make sure you have a stable Internet connection**

to ensure proper installation and activation.

**3**

### **Do not delete your eSIM**

You can only reinstall it up to two times on the same device.

**4**

### **If you are installing the eSIM using the QR code, make sure to display it on another device or print it so you can scan it.**

You received this QR code by email or you can find it directly on **Mi eSIM Telcel** portal.



# Installation and activation with a single touch



## How to install and activate your Telcel eSIM:

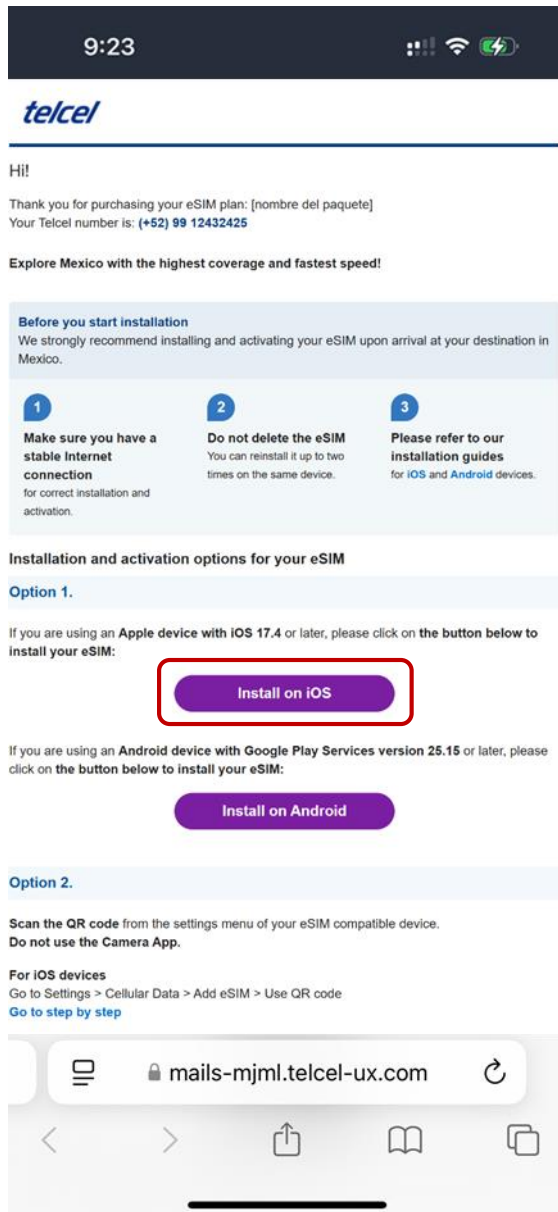

1.

Open the email **Your eSIM is ready! - Activation Guide** on the device where you will install the eSIM and tap the **“Install on iOS”** button

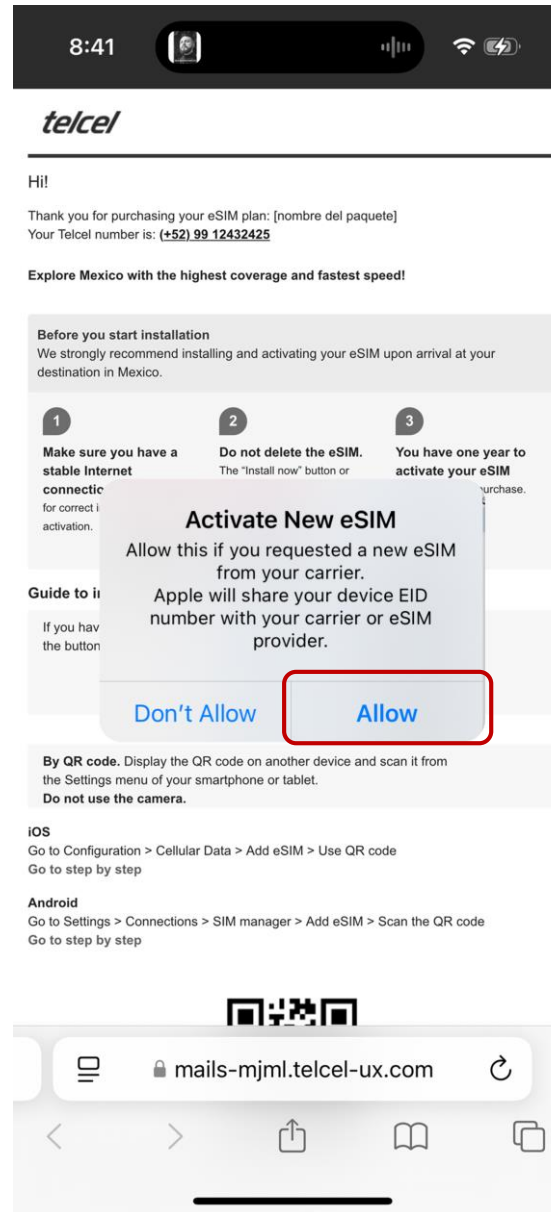

2.

Tap **“Allow”** option.

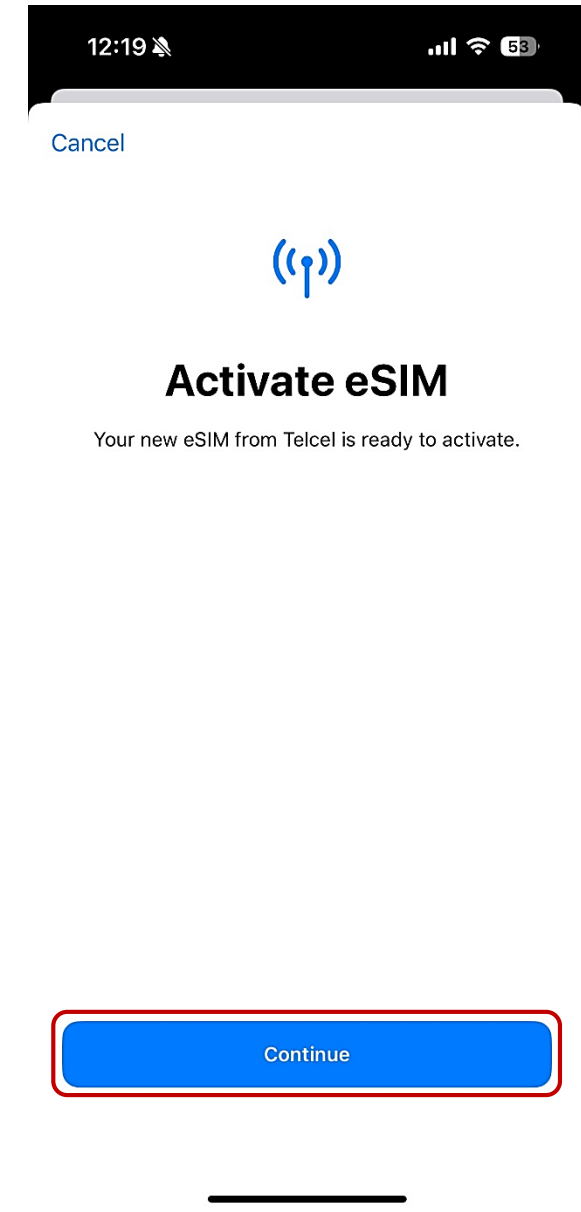

3.

Tap **Continue** to start the installation process of your eSIM

### How to install and activate your Telcel eSIM:

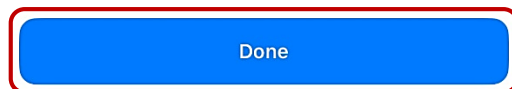

4.  
Your eSIM is now active.  
Tap [Done](#)



5.  
Select your new eSIM from Telcel  
and give it a name for  
identification. Click [Continue](#)

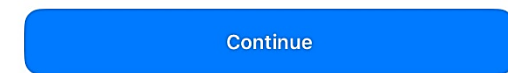

6.  
Select your Primary line as your  
default line and tap [Continue](#).

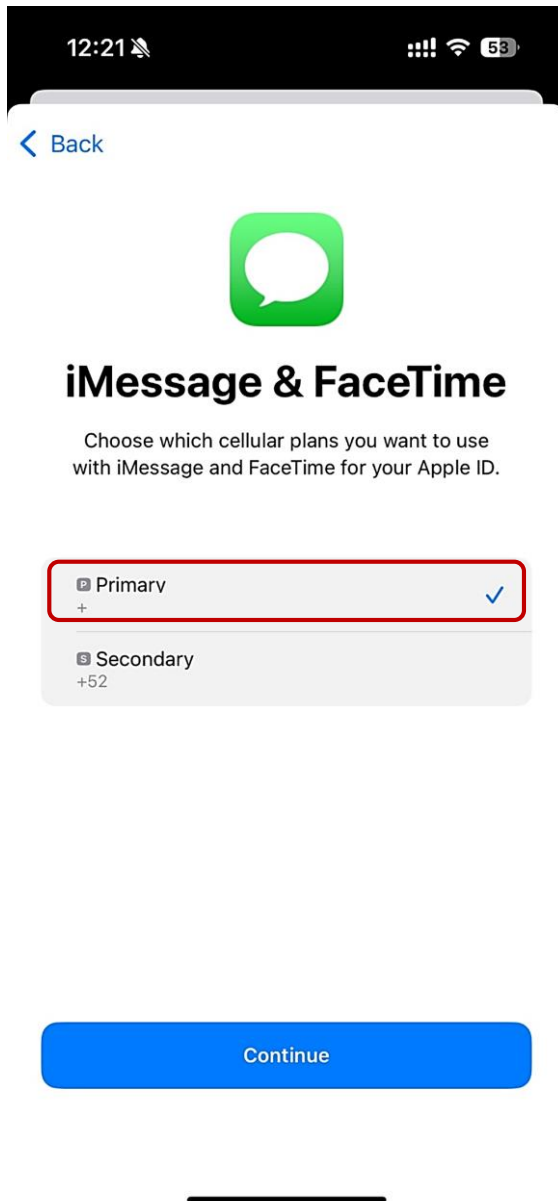

7.  
Select your Primary line for iMessage and Facetime and tap [Continue](#).

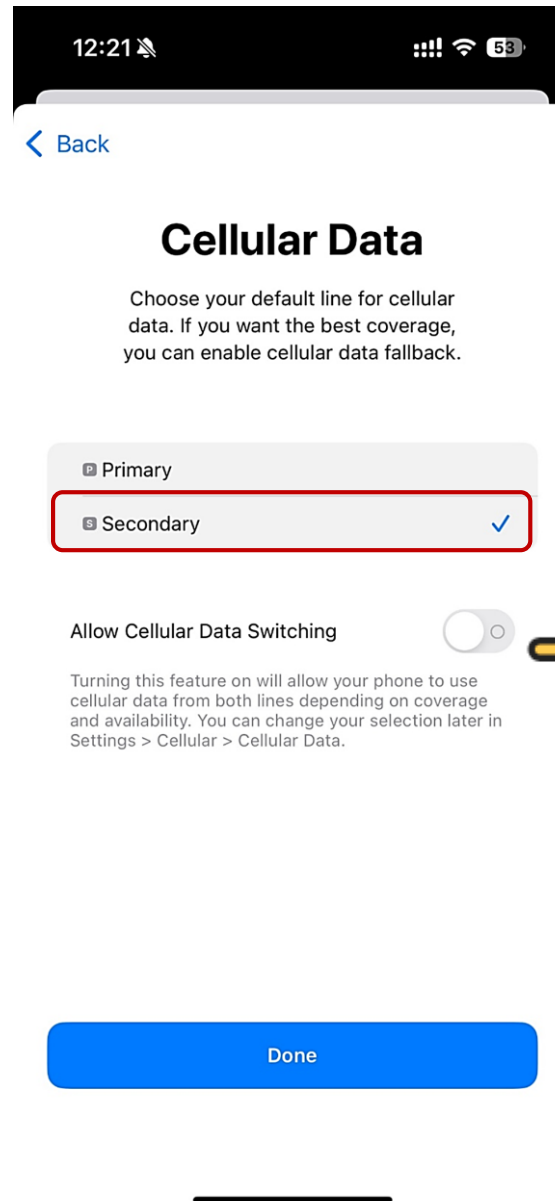

8.  
Select your new Telcel eSIM line for Cellular Data and click [Done](#).

Keep "Allow Cellular Data Switching" turned off to avoid Roaming charges on your Primary line.

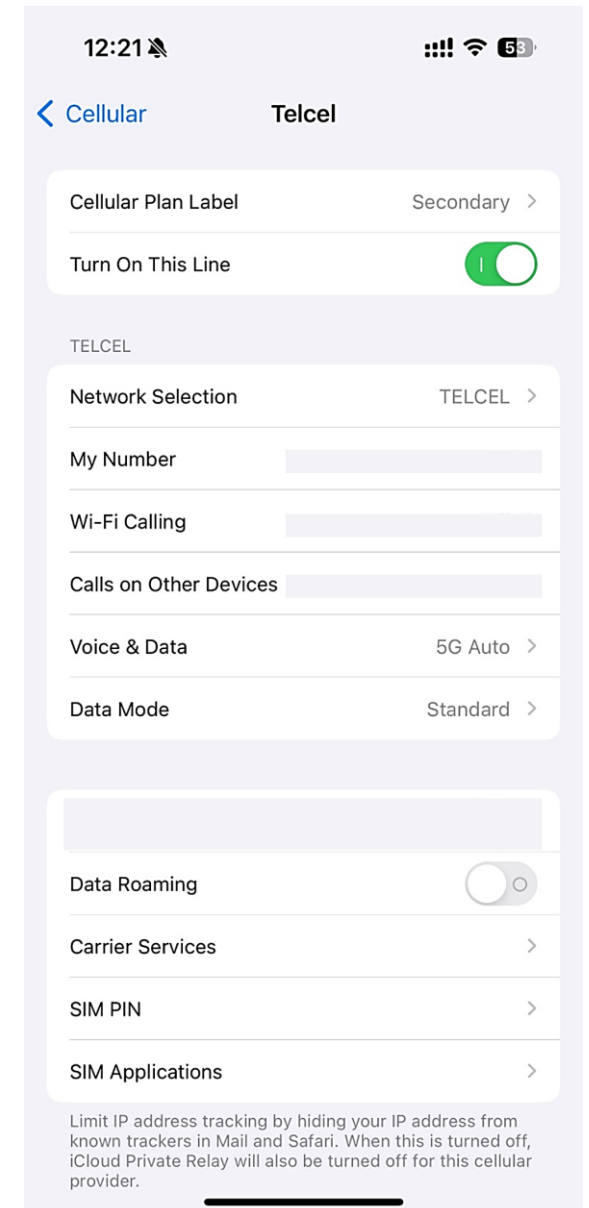

9.  
[Your Telcel eSIM is now active](#) and ready to navigate at the highest speed.

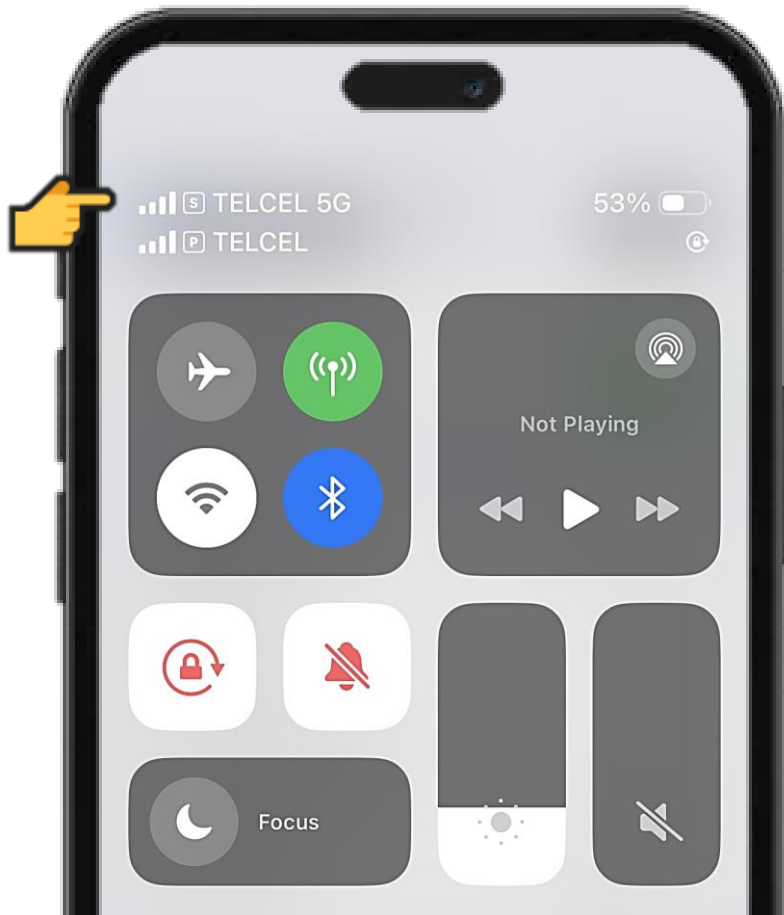

10.

**Make sure** there is at least one bar in the signal icon on your device.



# Installation and activation by QR code

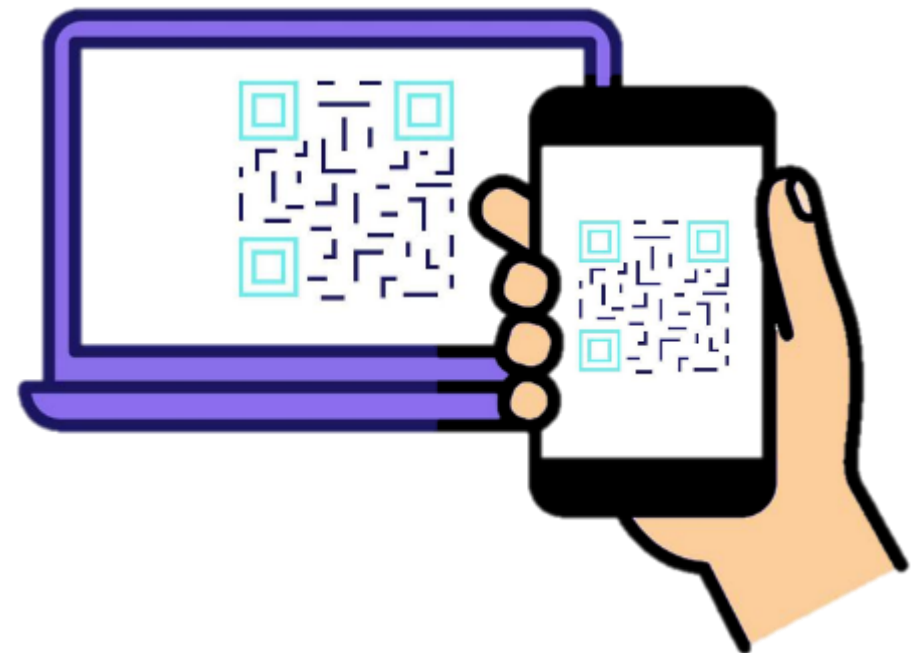



### How to install and activate your Telcel eSIM:

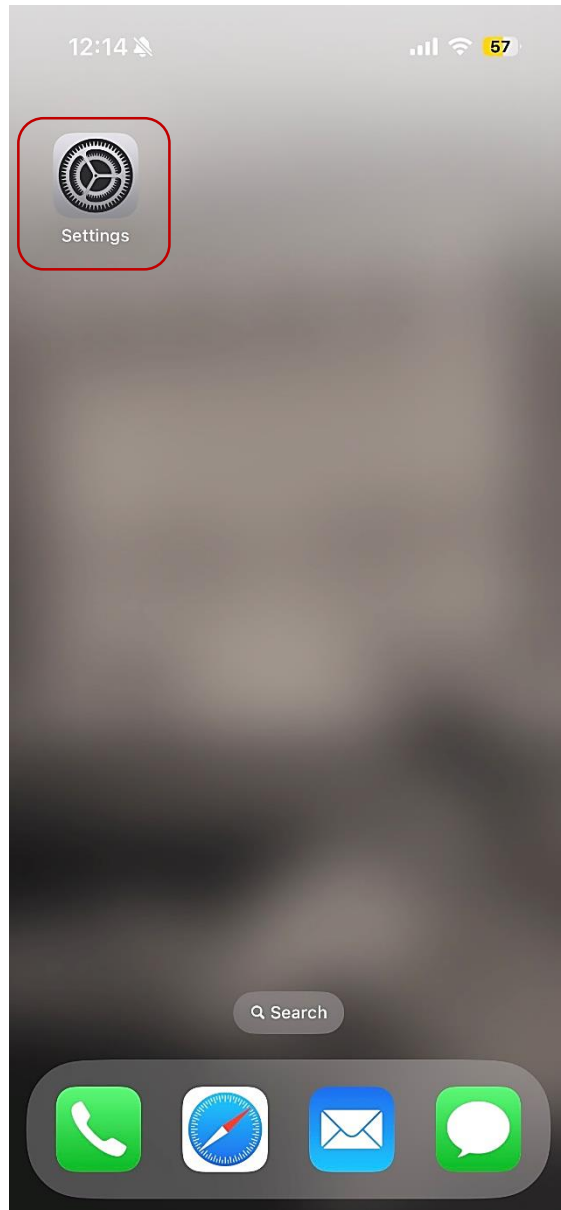

1.  
Go to **Settings**



2.  
Select **Cellular**

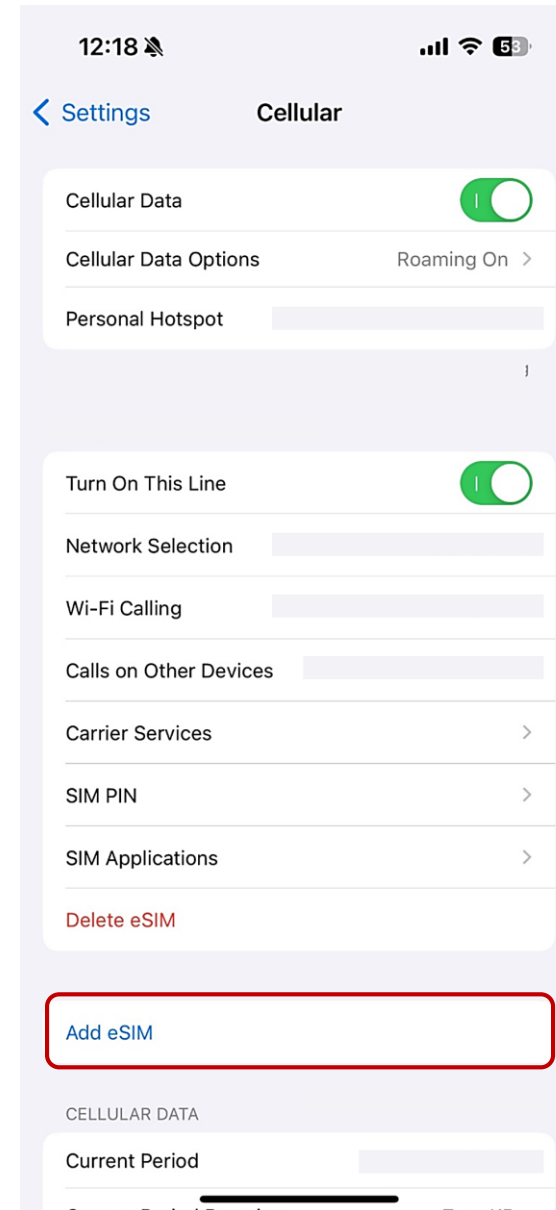

3.  
Tap **Add eSIM**

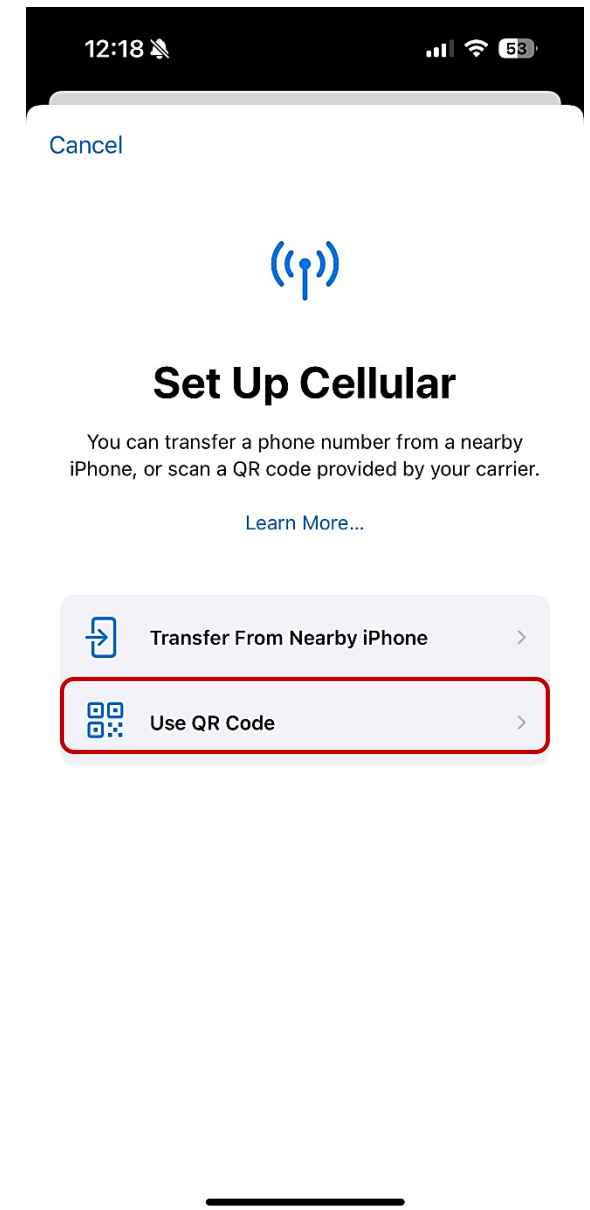

4.  
Select the option **Use QR Code**

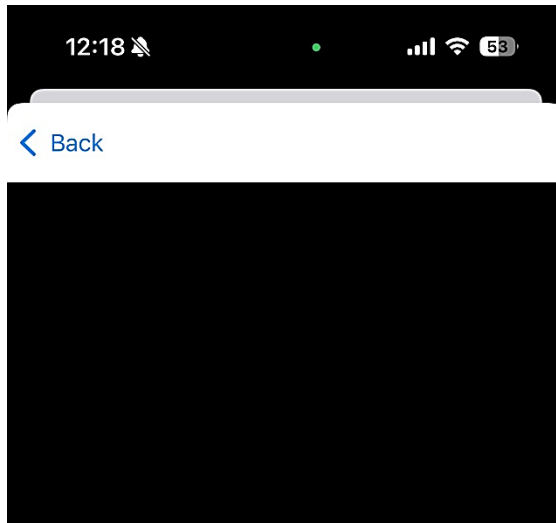

### Scan QR code

Position the QR code from your carrier in the frame.

[Learn More...](#)

[Enter Details Manually](#)

5.

Open the email **Your eSIM is ready!** - Activation on another device and scan the QR code with your device

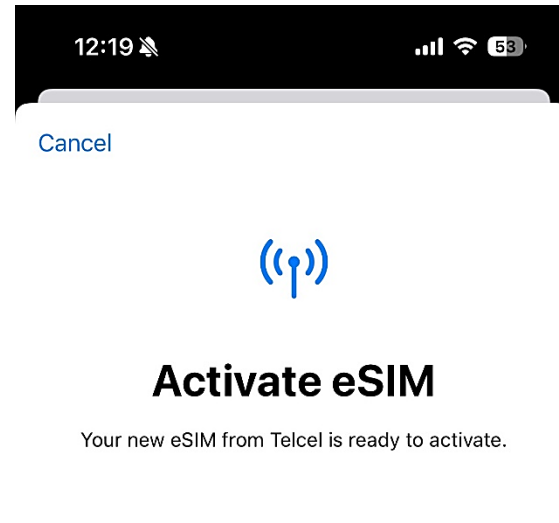

### Activate eSIM

Your new eSIM from Telcel is ready to activate.

Continue

6.

Tap **Continue** to start the installation process of your eSIM

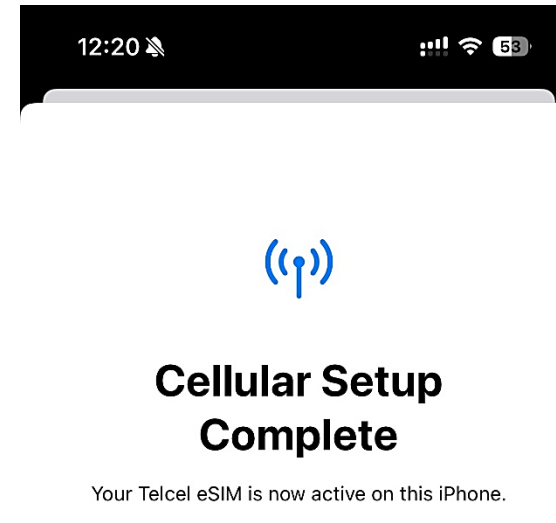

### Cellular Setup Complete

Your Telcel eSIM is now active on this iPhone.

Done

7.

Your eSIM is now active.  
Tap **Done**

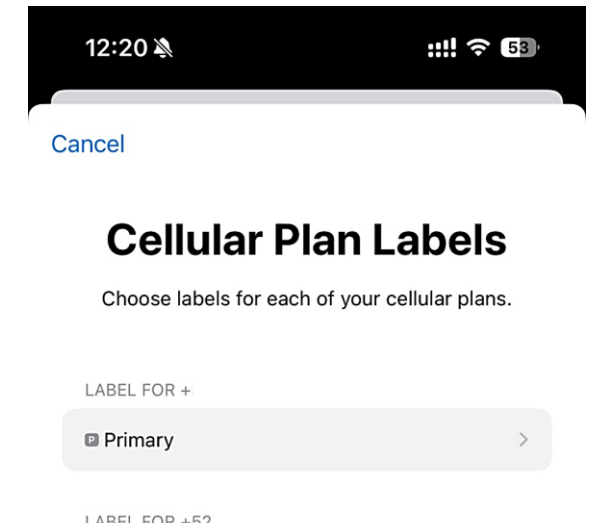

### Cellular Plan Labels

Choose labels for each of your cellular plans.

LABEL FOR +

Primary

LABEL FOR +52

Secondary

Continue

8.

Select your new eSIM from Telcel and give it a name for identification. Click **Continue**

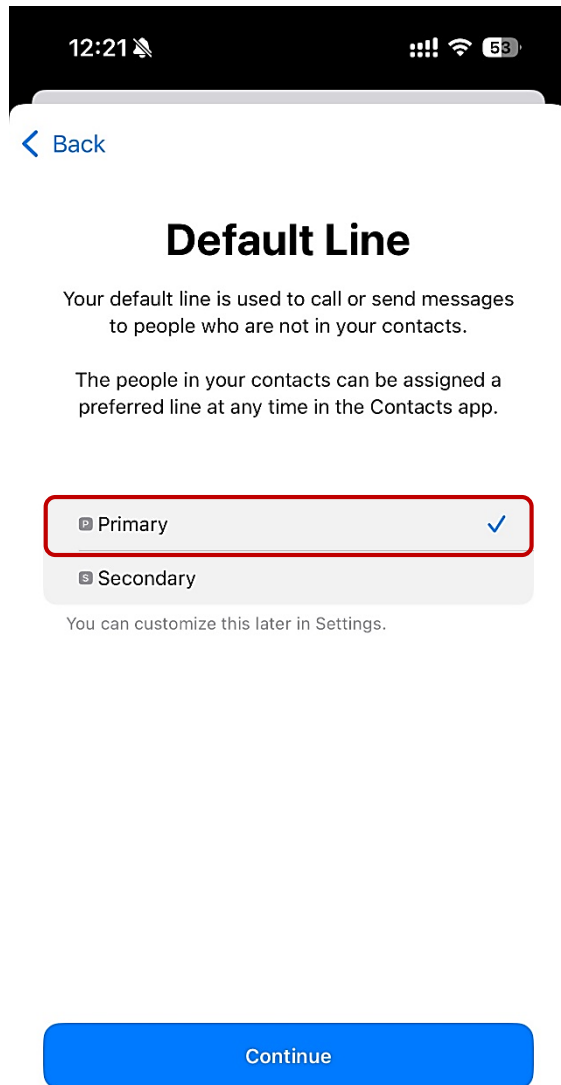

9.  
Select your Primary line as your default line and tap [Continue](#).

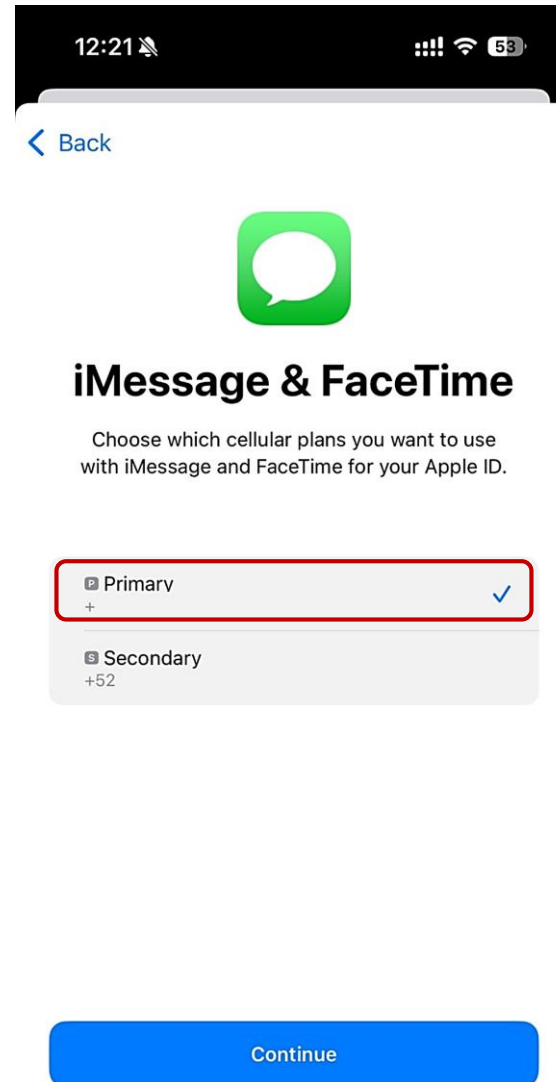

10.  
Select your Primary line for iMessage and Facetime and tap [Continue](#).

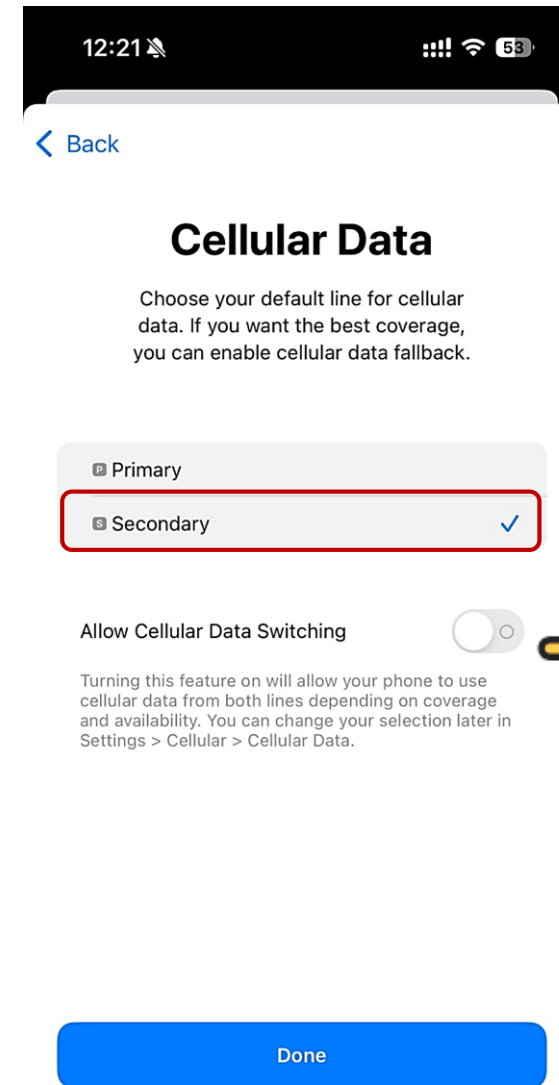

11.  
Select your new Telcel eSIM line for Cellular Data and click [Done](#).

Keep "Allow Cellular Data Switching" turned off to avoid Roaming charges on your Primary line.

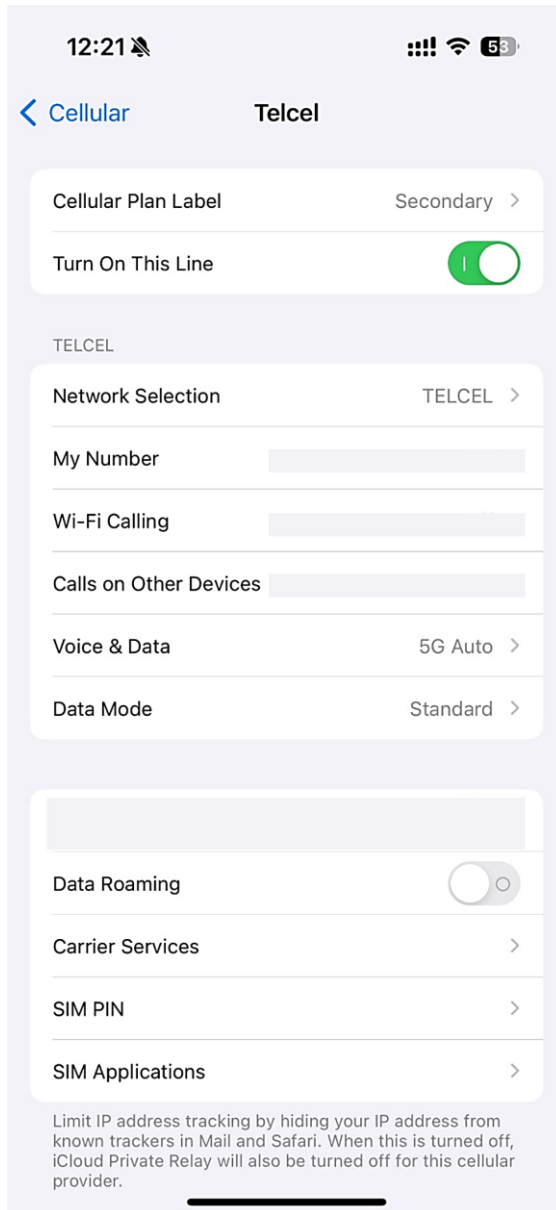

12.

Your Telcel eSIM is now active and ready to navigate at the highest speed.



13.

Make sure there is at least one bar in the signal icon on your device.



Have questions?

Visit the FAQ section at [Telcel.com](https://www.telcel.com)